

# HANDING GUIDE FOR PDQ's MR 136, 154, 157, 158, 159, 162 AND 179 FUNCTIONS

**DO NOT OPEN THE LOCK BODY.** ALL HANDING CHANGES ARE MADE BY POSITIONING THE SUPPLIED SCREWS AND PARTS WHICH ARE ACCESSED THROUGH THE EXTERIOR OF THE LOCK BODY.

NO ADDITIONAL PARTS ARE REQUIRED TO CHANGE THE HAND OF THIS LOCK BODY.

**IF YOU ARE REVERSING THE SWING (LH TO LHR FOR EXAMPLE) ALL YOU NEED TO DO IS REVERSE THE LATCH BOLT HEAD.**

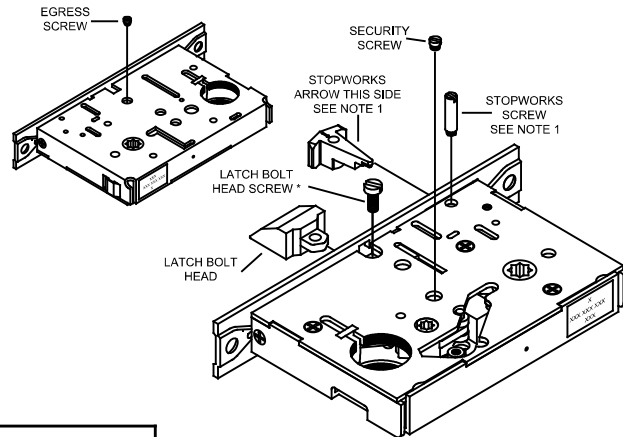

INSIDE



OUTSIDE

LEFT HAND (LH)

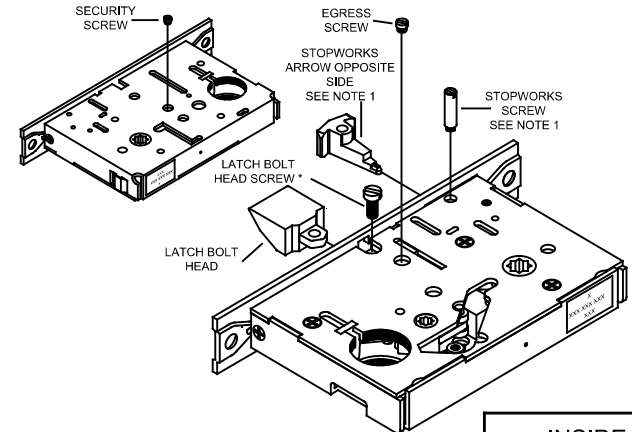

INSIDE

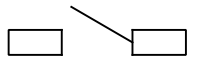

OUTSIDE

RIGHT HAND (RH)

BEFORE INSTALLING EGRESS OR SECURITY SCREW, EXTEND AND RETRACT DEADBOLT TO POSITION EGRESS LEVER AS SHOWN BELOW. ENSURE THAT EGRESS LEVER IS IN CORRECT POSITION.

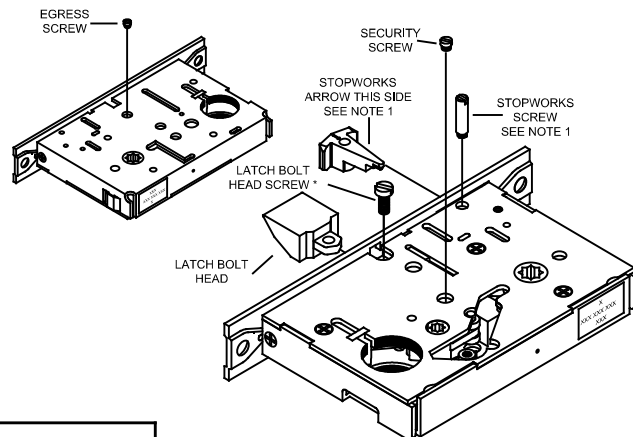
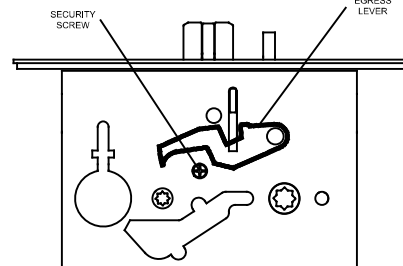

INSIDE

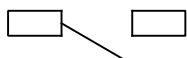

OUTSIDE

LEFT HAND REVERSE (LHR)

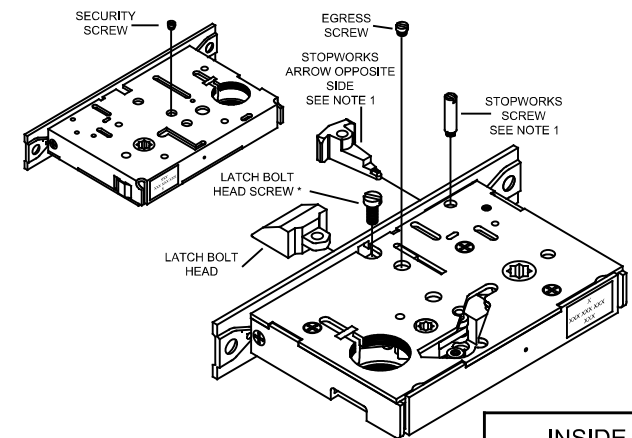

INSIDE



OUTSIDE

RIGHT HAND REVERSE (RHR)

## NOTES:

1 - STOPWORKS AND STOPWORKS SCREW ONLY APPLIES TO 154, 158 AND 162 FUNCTIONS

\* - APPLY PERMATEx'S LOCTITE 242 (BLUE), OR EQUIVALENT, TO THE LATCH BOLT HEAD SCREW.