



E6291(2) Exit Device Trim Installation Instructions

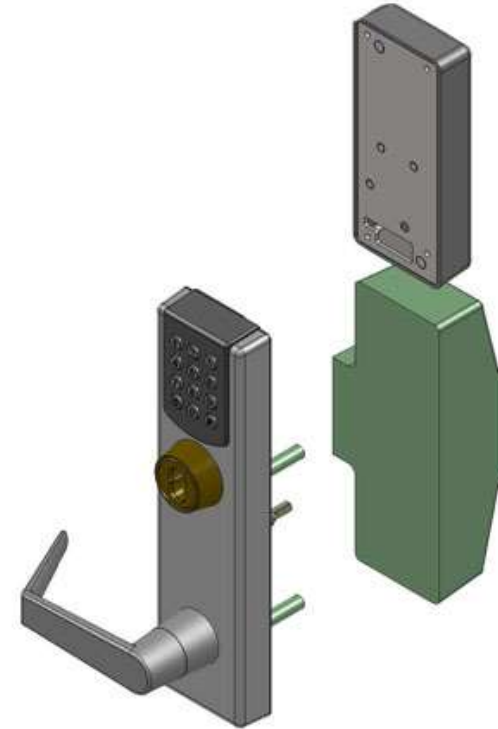

Table of Contents

| | |
|--|----|
| E629 Exit Device Trim Installation | 1 |
| Wiring Guide..... | 8 |
| Install Cylinder | 9 |
| Adjust for Door Thickness | 12 |

TellCard Systems
P.O. Box 485
Leola, PA 17540
855-200-2611

P/N 88309 Rev 1 10/30/13



E629 Exit Device Trim Installation

Screw Pack (P/N 88654)

- Four #8-32 x 3/4" panhead sheet metal screws
- Four 1/4-20 x 3/4" flathead screws
- One square lever drive spindle

1. If necessary, prepare door, using template (P/N 88310).



2. Hand trim (1). Install lever drive spindle (2).

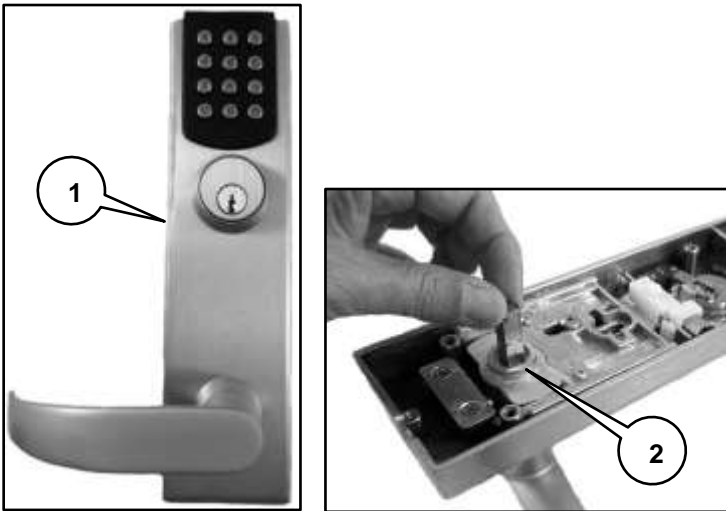

Adjust for Door Thickness

Trim is factory preset for an 1-3/4" door.

1. Remove screw (25) from drive pin (24).
2. Move pin to 2" or 2 1/4".
3. Reinstall screw.

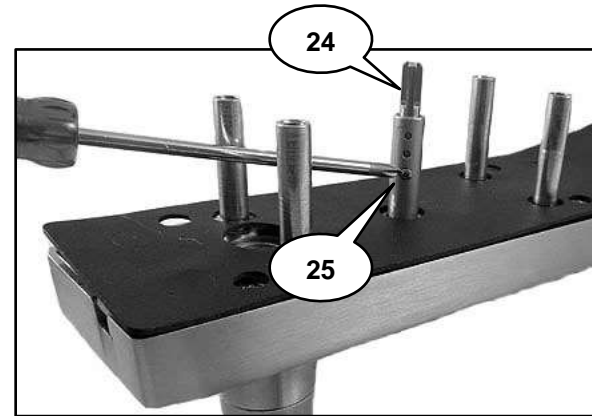

Install Cylinder (Cont'd)

- Align drive pin (24). Install back plate (23) with six screws (22).

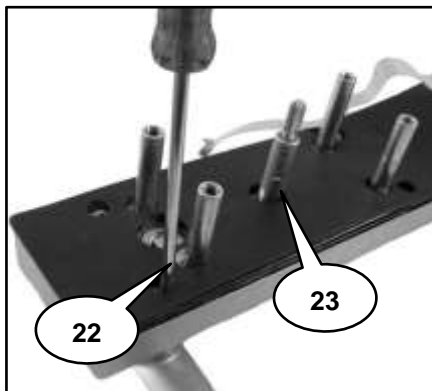
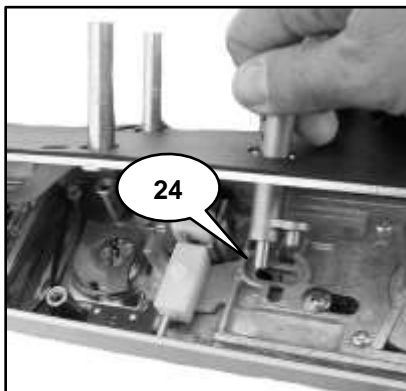

E629 Exit Device Trim Installation (Cont'd)

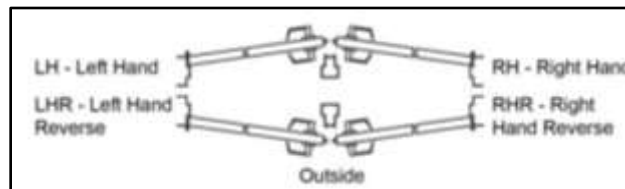

- Install trim (1). Route main wire harness (3) and motor cable (4) through door. Gently pull excess wire through door while installing trim to avoid pinching wires.

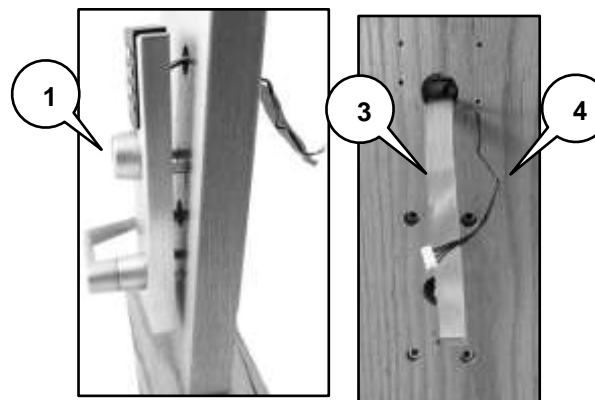

- Install exit device chassis (5). Secure with four 1/4-20 x 3/4" panhead screws (6).

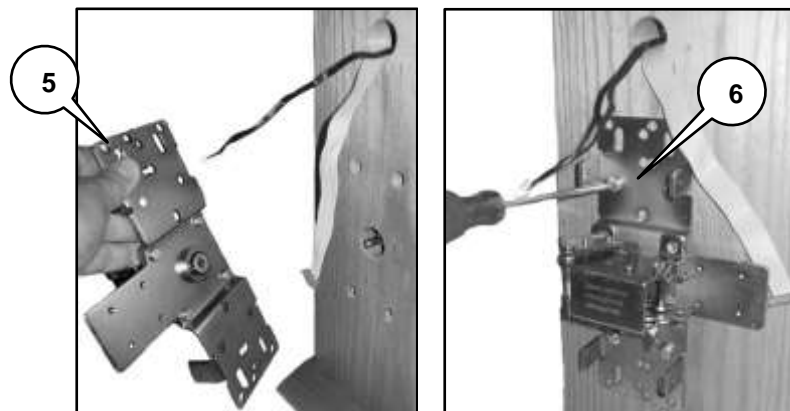

Note: Exit device head shown removed from device for clarity.
Do NOT remove head from chassis.

E629 Exit Device Trim Installation (Cont'd)

For E6291 RIM device, go to Step No. 5:

For E6292 SVR device, go to Step No. 8 on page 5:

5. Install exit device head cover (7). Secure with four #8-32 x 1/4" flathead screws (8).

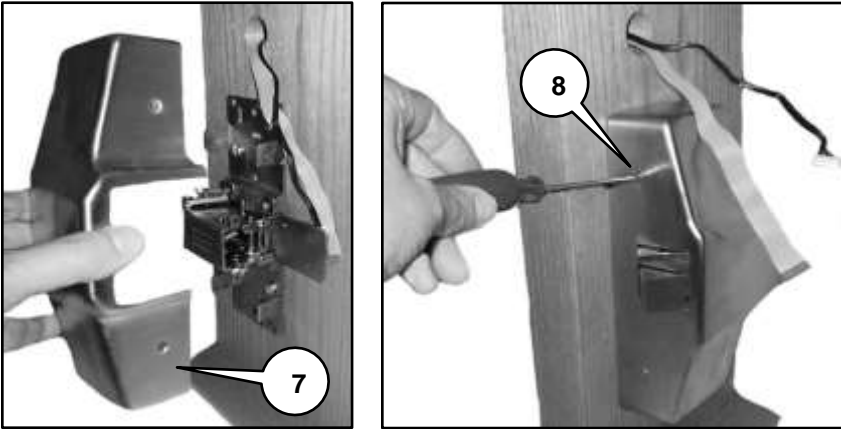

6. Route main wire harness (3) and wire cable (4) through battery box baseplate (9).

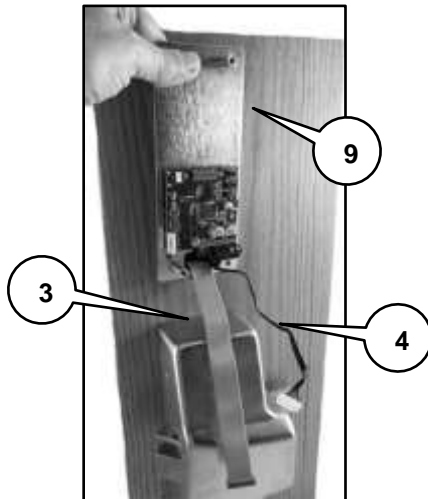

Install Cylinder (Cont'd)

2. Install wave spring (e) and cylinder (d) into the collar (c).

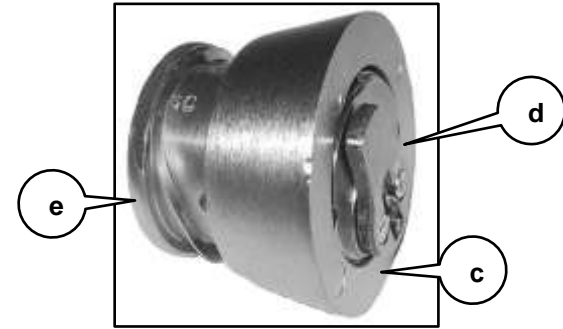

3. Install cylinder and collar assembly into trim. Install cylinder (b) locking plate and cylinder lock nut (a).

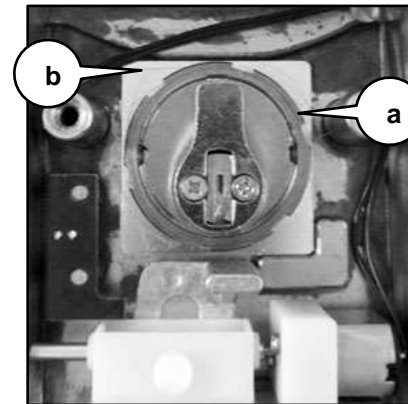

Install Cylinder

Key/Cylinder Parts List

- a. Cylinder Lock Nut (P/N 88644)
- b. Cylinder Lock Plate (P/N 88608)
- c. Cylinder Collar (Refer to Cylinder Length Chart for P/N)
- d. Mortise Cylinder
- e. Wave Spring (P/N 88657)



Cylinder Length Chart

| Cylinder Length | Collar P/N |
|-----------------|------------|
| 1 1/8" | I5504-XX |
| 1 1/4" | I5504-XX |
| 1 1/2" | I5503-XX |

1. Remove six screws (22) and back plate (23).

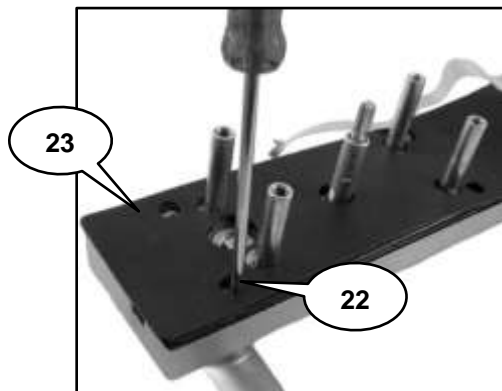

E629 Exit Device Trim Installation (Cont'd)

7. Install battery box baseplate (9). Secure with four #8-32 x 3/4" panhead sheet metal screws (10).

For E6291 RIM device, proceed to Step 12.

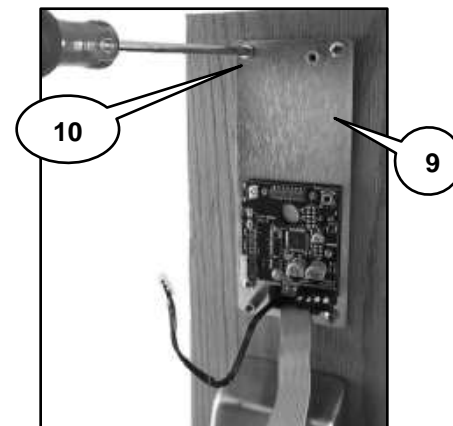

E629 Exit Device Trim Installation (Cont'd)

For Model E6292 SVR Device

SVR Riser Screw Pack (P/N 88656)

- Four #8-32 x 3/4" panhead sheet metal screws
- SVR rod cover

8. Route main wire harness and motor cable through SVR spacer (11).

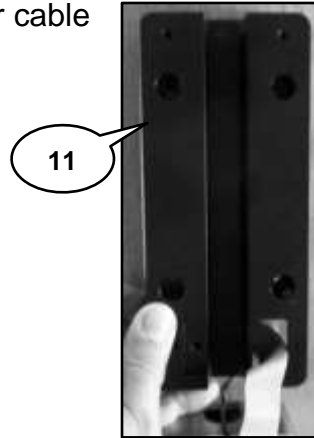

9. Secure SVR spacer (11) with four #8 x 3/4" panhead sheet metal screws (12).

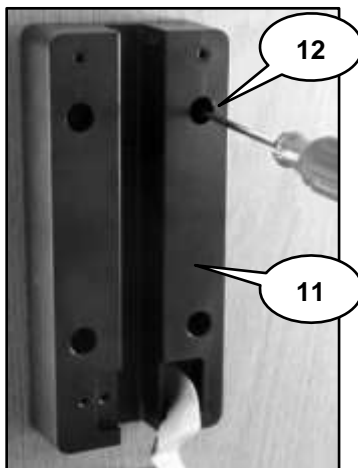

E629 Exit Device Trim Installation (Cont'd)

Hard Wired (External Wire Connection) Installation

14. Terminate wires into black terminal(s) (21). See Terminal Connections.

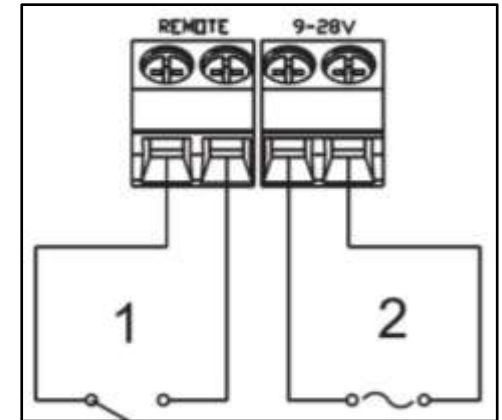
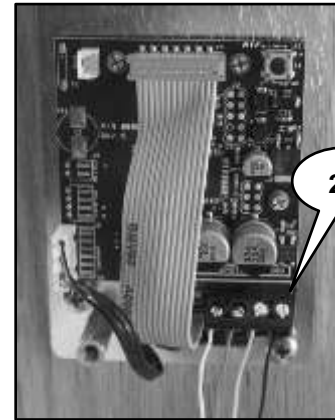

1. Remote Release Switch – SPST – N.O.
2. External Power – 12V to 24V AC or DC. Polarity not important

Wiring Guide

Power may be supplied one of three ways:

1. Four AA alkaline batteries
2. Hard wired to 12V to 24V DC Power Supply
3. Hard wired to 12V to 24V AC Power Supply

External Power Requirements

- Voltage: 12 to 24VDC or 12 to 24VAC
- Current: Max current 0.30A

E629 Exit Device Trim Installation (Cont'd)

12. Connect main wire harness (3) and motor cable (4) to circuit board.

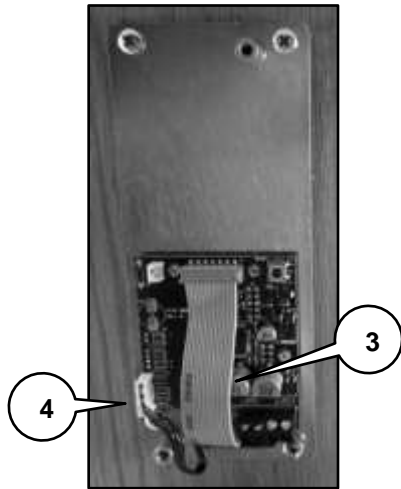

13. Install four AA batteries into battery pack (19). Connect battery pack to white terminal (20) on circuit board. Install battery pack/cover. Secure with two screws.

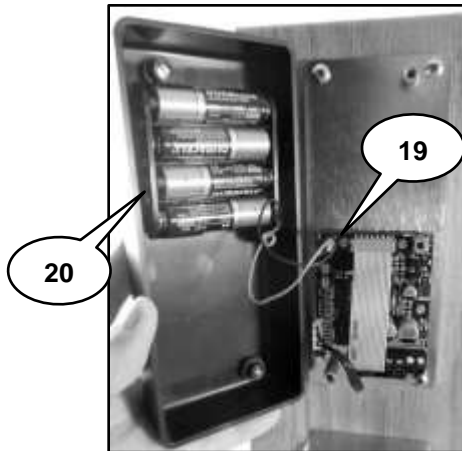

E629 Exit Device Trim Installation (Cont'd)

10. Install top rod (13) and device head cover. Install SVR rod cover (14). Secure with one #8 x 3/4" panhead sheet metal screw (15).

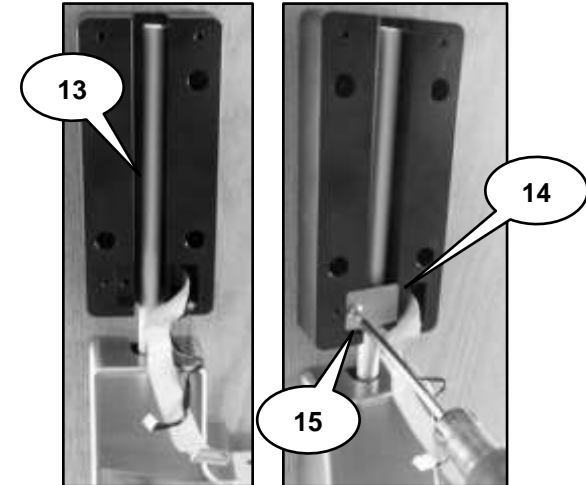

11. Install battery box baseplate (16).

12. Secure with three #8 x 3/4" panhead sheet metal screws (17).

